

# EST110 One wire grain temperature sensor



## SPECIFICATIONS

### EST110 1-Wire grain temperature sensor

Measuring range	-10~85°C
Resolution	0.1 °C
Accuracy	±0.5 °C
Length	Max. 30 m
Sensor amount	Max. 30 pcs
Sensor interval	Every 1 m
Cable material	PVC coating
Tensile strength	2500 kgf(Standard) 5000 kgf(Optional)
IP rating	IP67

### HubLink (1-Wire)

Supply voltage	10~30 Vdc
Ambient temperature	40~80°C
Connection port	Max. 4
Housing	Aluminum alloy (ADC-12)
Communication interface	RS-485
Sensor	1-Wire digital temperature sensor
RS-485 baud rate	9600 ~115200
IP rating	IP67

## DESCRIPTION

Temperature is crucial to maintaining the grain quality in a grain storage system. Whenever grain rots or when there is a pest problem, the temperature in the silos will rise to indicate there is a problem. The multiple sensing points of EST110 one wire temperature sensor is capable of measuring temperature changes inside the silos to enhance real time temperature monitoring.

Compared with traditional manual temperature measuring, EST110 is an efficient grain temperature monitoring unit. By connecting to HubLink which provides RS-485 communication interface to transmit temperature data to control center or HMI, users can remotely retrieve and monitor temperature changes inside the storage silos efficiently.

## FEATURES

- Strengthened steel cable design to sustain impact from media to prolong product life.
- Multi-points temperature sensing to enhance prompt management of grain temperature control.
- Detection of rotting grain or pest damage to maintain quality of the grain.
- Real time monitoring of silo temperature for food, animal feed, grain and etc., to extend media preserve.
- Prevent grain rotten or fire caused by high temperature.
- Customized sensor spacing along cable.
- RS-485 communication interface.
- HubLink with wireless transmission functionality.

## APPLICATIONS

- Rice mill
- Flour mill
- Feed industry
- Food industry
- Low temperature grain storage
- Sold level requires multiple points temperature monitoring

## DIMENSION

(Unit:mm)

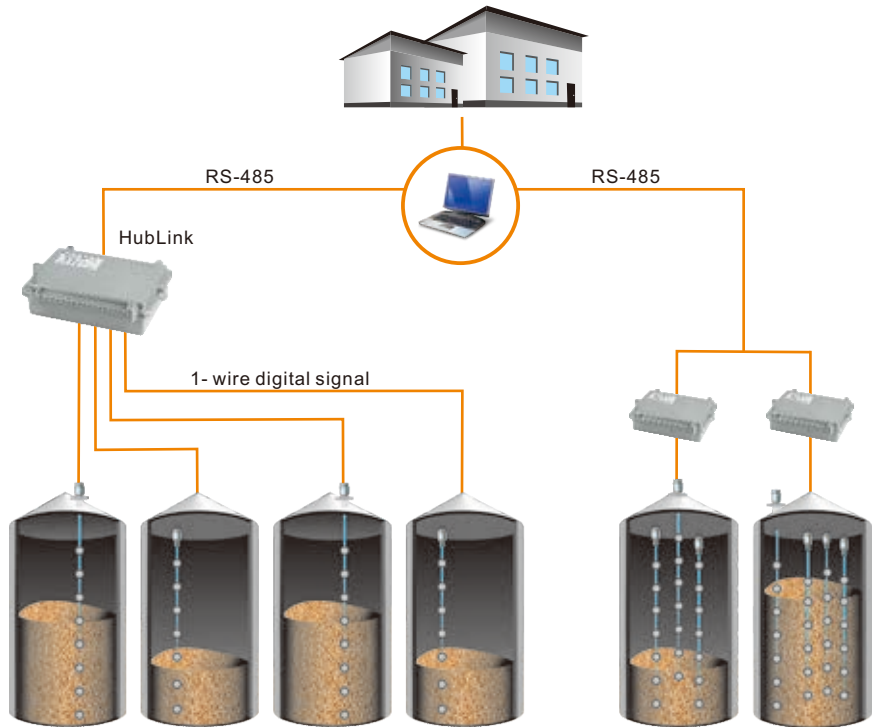
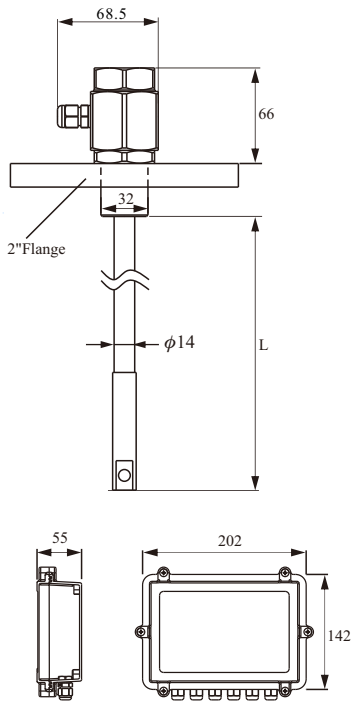

## ORDER INFORMATION

EST110-**F****M****3****0**-**1****0**-**3****0**

Connection

Size E: 1-1/2" F: 2" G: 2-1/2" H: 3" I: 4" J: 5" K: 6"  
 Specification M: 5kg/cm<sup>2</sup> N: 10kg/cm<sup>2</sup> O: 150Lbs P: 300Lbs

Length (Unit:m)

01: 1m(min.)  
 02: 2m  
 ...  
 30: 30m(max.)

Sensor interval

05: One sensor every 0.5m  
 10: One sensor every 1m (std.)  
 15: One sensor every 1.5m  
 20: One sensor every 2.0m  
 ...  
 95: One Sensor every 9.5m (max.)

Sensor amount

01: 1Pcs  
 02: 2Pcs  
 ...  
 30: 30Pcs(max.)